



Sanitary barrier washer extractors



Wide range of sanitary barrier machines meeting maximum demands



Power, control and total decontamination

The stringent RABC hygiene standards require powerful machines with specific washing processes for hospitals, residential care homes, the pharmaceutical, nuclear and cosmetic industries, prisons, etc.

Fagor offers an extensive range of sanitary barrier machines, and is noted for the advanced technology, high G factor and easy installation, ergonomics and connectivity. With capacities from 16 to 100 kg; they are ideal for adapting to the needs of such a demanding market. Installed between two separate areas, preventing any contact between the dirty and clean linen, and any type of re-contamination during the process.

All the barrier washers are equipped with Touch Plus TP2 microprocessor and 7" touch screen, with features guaranteeing maximum EFFICIENCY, TRACEABILITY and HYGIENE.

Sanitary barrier washer extractors | LMED

TYPE OF CONTROL	HEATING	CAPACITY	
		16-18 kg	22-25 kg
TP2 Programmable control	Electric, steam and dual (electric + steam)	LMED-16 TP2	LMED-22 TP2

Sanitary barrier washer extractors | LBS

TYPE OF CONTROL	HEATING	CAPACITY			
		27-30 kg	35-39 kg	49-54 kg	70-78 kg
TP2 Programmable control	Electric, steam and dual (electric + steam)	LBS-27 TP2	LBS-35 TP2	LBS-50 TP2	LBS-70 TP2

Sanitary barrier washer extractors | PULLMAN

TYPE OF CONTROL	HEATING	CAPACITY			
		27-30 kg	35-39 kg	49-54 kg	90-100 kg
TP2 Programmable control	Electric, steam and dual (electric + steam)	LBS-27 TP2 PULLMAN	LBS-35 TP2 PULLMAN	LBS-50 TP2 PULLMAN	LBS-100 TP2 PULLMAN

LMED

Factor G
350



Characteristics

- Sanitary barrier with 2 opposing doors (180°) with a sanitary partition wall.
- 16 and 22 kg models.
- G Factor of 350.
- TP2 microprocessor with 7" touch screen.
- Two water inlets.
- Panels in grey skin plate, stainless steel upper panel.
- Central drainage.
- Automatic drum positioning.
- Heating: electric, steam.
- New dual heating model (electric + steam).

LBS

Factor G
375



Characteristics

- Sanitary barrier with 2 opposing doors (180°) with a sanitary partition wall.
- 27, 35, 50 and 70 kg models.
- G Factor of 375.
- TP2 microprocessor with 7" touch screen.
- Standard dual panel.
- Panels in grey skin plate and stainless steel upper panel.
- AISI 304 stainless steel drum and tub.
- Three water inlets.
- Central drainage.
- Automatic drum positioning with electric brake.
- Heating: electric, steam.
- New dual heating model (electric + steam).

 PULLMAN

Factor G
375



Characteristics

- Sanitary health barrier with Pullman partition.
- 27, 35 and 50 kg models.
- 375 G factor.
- TP2 microprocessor with 7" touch screen.
- Standard dual panel.
- Three water inlets.
- Panels in grey skin plate and stainless steel upper panel.
- AISI 304 stainless steel drum and tub.
- Central drainage.
- Automatic drum positioning with electric brake.
- Heating: electric, steam.
- New model dual heating option (electric + steam).

Factor G
325



Characteristics

- Sanitary health barrier with Pullman partition.
- 100 kg models.
- 325 G factor.
- TP2 microprocessor with 7" touch screen.
- Standard dual panel.
- Three water inlets.
- Panels in grey skin plate and stainless steel upper panel.
- AISI 304 stainless steel drum and tub.
- Central drainage.
- Automatic drum positioning with electric brake.
- Heating: electric, steam.
- Dual heating option (electric + steam).



Touch Plus Control

- Easy-to-use microprocessor and fully programmable with 7" touch screen.
- **8 standard dispenser signals.**
- **Screen on both sides of the machine** - touch screen in dirty zone and display only in the clean zone to display the state of the washing programme (optional for 16 and 22 kg LMED models).
- **USB port.** Free software for programming, traceability, data analysis...
- **Designed for remote communication** with **FagorKonnnect** licence.
- Personalisation of programmes as required.
- **Wet Cleaning.**
- **Hygiene-Standard traceability.**

OPTIONS

- Printer.
- 6 extra dispenser signals.



Ergonomics

- **Large doors** to make loading and unloading easier. The largest in the market.
- **Easy-to-operate button-opening drum.**
- **Ergonomic height** to make loading of linen easier.

OPTIONS

- Plinth to align loading height (door base at 850 mm).



High performance

- **Dual screen** (optional in LMED models).
- **Automatic drum positioning**, with motor brake to make loading and unloading easier (optional in LMED models).
- **3 standard water inlets** (2 water inlets in the LMED range).
- **WET CLEANING:** equipped with the features required for WET programmes (very useful in residential care homes).
- Skin plate unit and upper stainless steel panel - **easy to clean.**
- **New dual heating model: electric and steam - energy saving.**

OPTIONS

- Soap drawer (in place of pumps).
- Second drainage for water recovery.
- Water connection valve for samples.
- UPS kit for releasing the drum brake in the event of power cut.
- AISI 304 stainless steel exterior unit.



Connectivity



- **Standard remote communication:** monitoring of the machine, error messages, remote desktop, **data recovery for technicians, software updates.**
- **Laundry management** allows you to monitor your business, see statistics, traceability, manage schedules, etc.



Efficiency

- **Water savings.**
Option to configure three savings levels.
- **Optimum Load** – optimum load (indicating weight).
- **Smart consumption:** automatic adjustment of water and detergent consumption (standard).
- **Prepared for water recovery tank.**
KRS (Kare Recovery System).
- **High G Factor.**
Reduced residual humidity > Reduced drying time.
- **Low water consumption:** less than 8.2 litres of water per kg and cycle (standard cycle at 60 °C).

OPTIONS

- Automatic weighing with sensors on the feet.



Maintenance

- **Electrical components on the left of the machine, mechanical components on the right of the machine and connections in the upper part.**
Easy access to all the components.
Easy connection, all connections protected from water and detergents.
- **Central drainage** - Easy installation.
- **Technician's menu:** statistics, alarms, autotest, data recovery for technicians and after sales maintenance..

OPTIONS

- Side drainage.
- Low steam pressure: to permit installation of steam-operated machine in facilities with low steam pressure.



Touch Plus TP2

Connectivity, traceability and efficiency are the most notable features of the Touch Plus TP2.

Touch Plus TP2 microprocessor. Fully programmable, with 7" touch screen"

Wash and spin speed configuration. Complete control of water levels. Water temperature adjustable from 20 °C to 90 °C.

Screen on both sides of the machine

Standard in LBS and LBS Pullman models
Touch screen in dirty zone and display only in clean zone to display the state of the wash programme (optional in LMED).

Standard Wet Cleaning

Equipped with the features required to use the Wet Cleaning system (useful in residential care homes).
Configuration of water levels, wash speed and temperature settings. 8 standard dispenser signals + 6 optional.

USB connection

USB port included for multiple tasks including: download traceability data, download/update programmes and their parameters, software updates, download error warnings or operating data.

Telemetry - Hygiene

The entire wash process (temperatures, water levels) is saved in the washer extractor and can be downloaded from a USB port or remotely with **FagorKonnnect** licence, helping to control the washing process and ensure compliance of the hygiene requirements (RABC standard).

37 languages

Available and easy to configure, thanks to the Fagor goal to be accessible to everyone.



High performance

Outer unit in skin plate

Stainless steel upper panel, easy to clean.
Optional AISI 304 stainless steel exterior unit.

3 water inlets

Standard in LBS, LBS Pullman (the third, optional in LMED).

Automatic drum positioning

Standard, with motor brake to make loading and unloading easier (optional in LMED).





Other options

- Sanitary health barrier with Pullman partition
- Soap drawer (in place of pumps)
- Dual heating (electric-steam): energy saving
- Second drainage for water recovery
- Sample valve

Efficiency

Fagor's new range of barrier washers has been designed with water, chemical and energy savings in mind to ensure optimum performance.

 **High G Factor, reduces residual humidity and drying time**

 **Water and chemical savings**
Possibility to configure 3 levels of water and chemical savings.

 **Optimum Load**
Manual display showing weight of the load (standard).



 **Automatic weighing with sensors on the feet**
optional (not available in LBS-100).

 **Tecnology**
We apply the latest technology to offer the most efficient machinery.



 **GREEN EVOLUTION FOR A SUSTAINABLE FUTURE.**

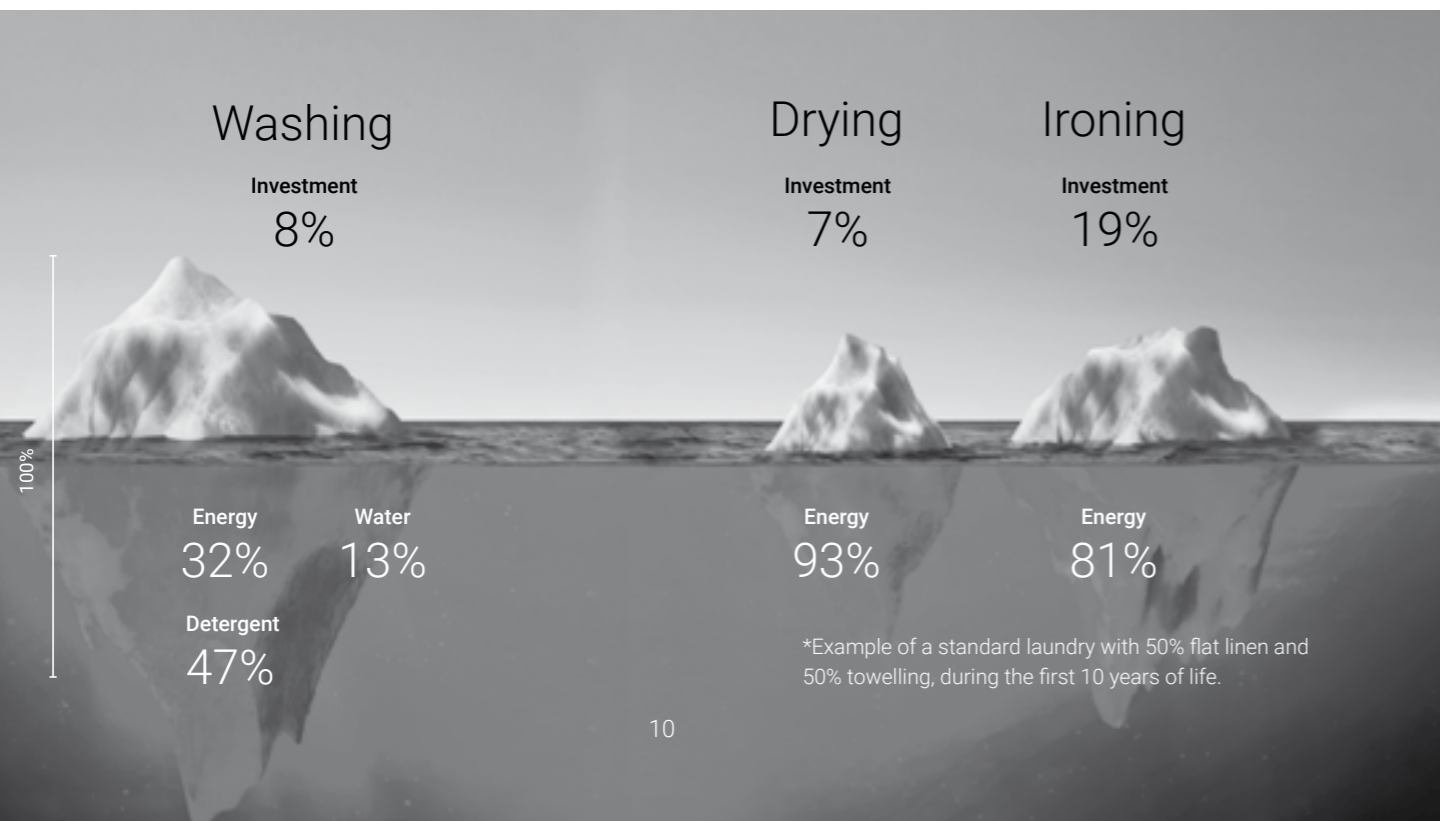

KRS water recovery system

Designed to be connected to a water recovery tank

Fagor barrier washers with Touch Plus TP2 control and dual drainage, can be connected to the new KRS tank, which enables water recovery obtaining major savings in water and energy consumption.

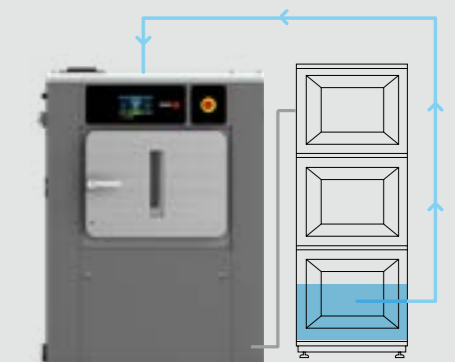

Extensive range

Volumes of 80, 150 o 1000 L

Water savings

Models with 1, 2 or 3 tanks.

Ergonomics

As occupational health and safety has become an important matter, our machinery is designed to be comfortable to use.

Wide door opening

making loading and unloading linen easier, greater opening in the market.

Ergonomic loading height

Plinth to align loading height

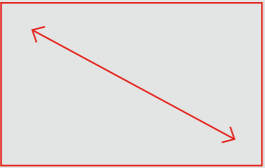

Large doors:

- LBS-27**
542 x 650 mm
- LBS-35/50**
700 x 650 mm
- LBS-70**
1402 x 650 mm
- LBS-100**
960 x 700 mm

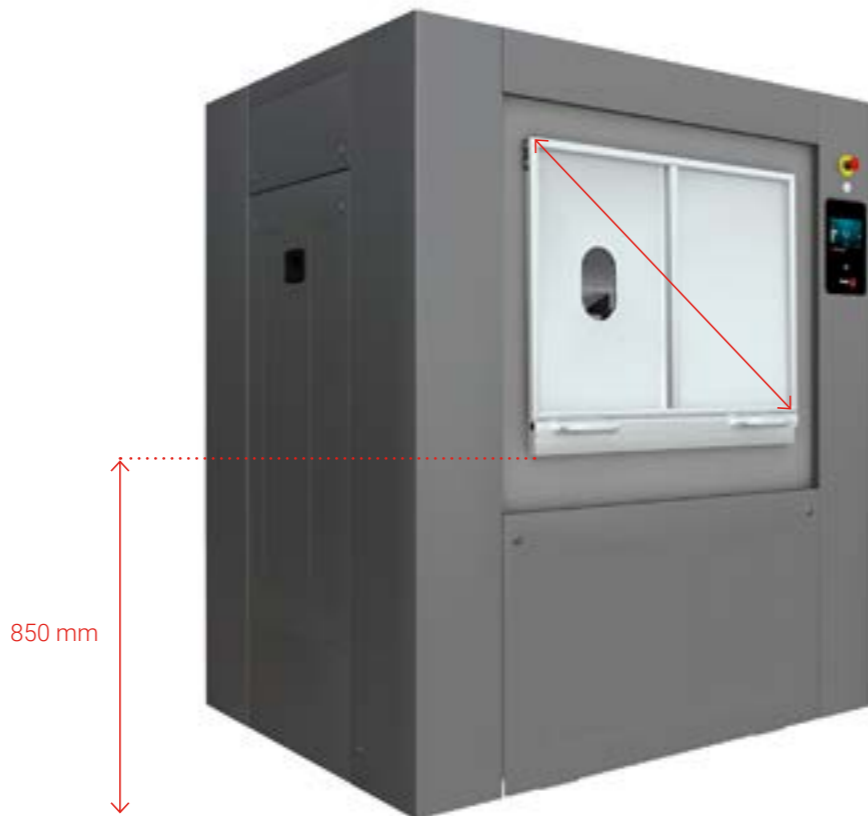

(door base at 850 mm except LBS 100)

Button-operated drum opening, easy to use

Connectivity

A connected world, a world of benefits



Free and easy IoT connection is standard across all ranges with Touch Plus

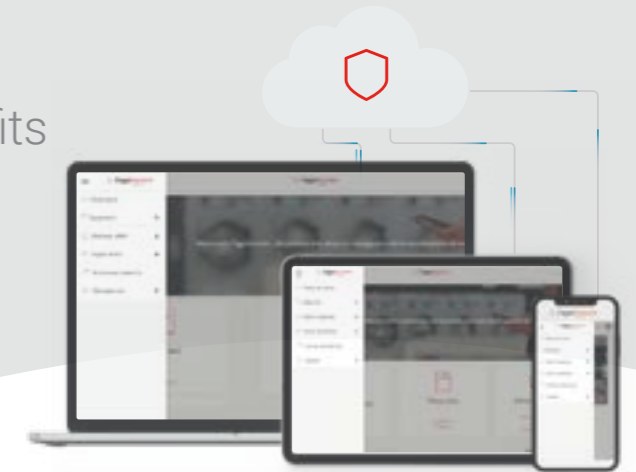

Features and functions

Management

- Management of washing and drying programs and phases.
- Configurable statistics, cycles carried out, income (Coin), errors, productions, production reports and water, chemical and energy consumption, workloads, etc.
- Creation of daily, weekly reports, etc. Sending by email with the information and statistics.
- Telemetry: storage and access of all data and signals from the machines for later use and consultation (times, temperatures, errors, water levels, dosages, etc.). Very useful for users, technical services, chemists, etc.
- Machine configurations.
- Remote control of machines.
- Geolocation.

Technical service

- Configuration of sending notifications and errors.
- Access to technical documentation, videos, manuals, exploded views, electrical diagrams, etc.
- Management of interventions.

Important advantages

Owner / end user

Improves usability, efficiency and comfort.
Business control: configurable reports of production, cycles, consumption, revenue,...

Ensure the washing and drying processes, ensure hygiene and disinfection, washing quality...

+ information + security + control

Telemetry

Custom graphics for monitoring of your business.

Technical service

Improvement of customer service.
Improvement of processes (more efficient and lower costs) avoiding unnecessary trips.
Remote troubleshooting and maintenance programs.
Telemetry and complete information of all the programs carried out.
Access to technical documentation, videos, etc.

+ efficiency + support + information

SAT - trouble shooting

Dealer

Technological base for new business (renting, maintenance contracts, self-services...).

Databases of installed machines (geographical distribution, models...).

Added value of **FagorKconnect** machines for the customer.

+ opportunity + information + added value

Chemical partners

Management and creation of washing and drying programs (online and offline).
Ensure the washing and drying processes, ensure hygiene and disinfection, washing quality...
Troubleshooting and remote management.
Telemetry and complete information of all the programs carried out.

+ information + management + ease



Maintenance

One of Fagor's main objectives is to make life easier for our customers. This includes offering quality machinery and parts by recognised names requiring low maintenance.

Easy access to components for repairs

Electrical components on the left of the machine, mechanical components on the right of the machine and connections in the upper part. Easy connection, all connections protected from water and detergents.

Technical service menu

Statistics, alarms, autotest, data recovery for technicians and after sales maintenance.

Central drainage

Easy installation.



Other options

- Side drainage
- Low steam pressure: to permit installation of steam-operated machine in facilities with low steam pressure

Technical data

	UNIT.	LMED-16	LMED-22	LBS-27	LBS-35	LBS-50	LBS-70	LBS-100
Drum								
Load capacity 1:9	Kg	18	25	30	39	54	78	100
Load capacity 1:10	Kg	16	22	27	35	49	70	90
Volume	l	158	220	266	347	489	694	900
Diameter	mm	633	633	800	800	800	800	1050
Depth	mm	500	700	530	690	974	1380	1032
Drum compartments		1	1	1 2 (Pullman)	1 2 (Pullman)	1 2 (Pullman)	2	2 Pullman
General data								
Wash speed	r.p.m.	45	45	45	45	45	45	45
Spin speed	r.p.m.	1000	1000	920	920	920	920	750
G Factor		350	350	375	375	375	375	325
Double drainage		OPT	OPT	OPT	OPT	OPT	OPT	STD
Touch Plus TP2 screen		7"	7"	7"	7"	7"	7"	7"
Dual screen		OPT	OPT	STD	STD	STD	STD	STD
Electric motor brake		OPT	OPT	STD	STD	STD	STD	STD
Plinth of height		OPT	OPT	OPT	OPT	OPT	OPT	N/A
3 water inlets		OPT	OPT	STD	STD	STD	STD	STD
Door								
Drum opening dimensions	mm	400x315	400x315	480x515	640x515	640x515	2x(640x515)	900x500
Vat opening dimensions	mm	455x415	455x415	542x650	700x650	700x650	1402x650	960x700
Height of door base	mm	670	670	800	800	800	800	960
Powers								
Motor (kW)	kW	2,2	2,2	4	4	5,5	7,5	15
Heating (kW) (electric/dual model)	kW	12	18	18	27	36	45	60
Max. power (kW) (electric model)	kW	14,2	20,2	22	31	41,5	52,5	75
Max. power (kW) (steam model)	kW	2,2	2,2	4	4	5,5	7,5	15
Connections								
Water inlet	inch	3/4"	3/4"	3/4"	3/4"	1"	1"	1"
Steam inlet	inch	3/4"	3/4"	3/4"	3/4"	3/4"	3/4"	3/4"
Drainage (mm)	inch	3"	3"	3"	3"	3"	3"	3"
Compressed air inlet	mm	N/A	N/A	N/A	N/A	N/A	N/A	8
Dimensions								
Width (mm)	mm	1.056	1.245	1.264	1.422	1.717	2.124	1.742
Depth (mm)	mm	1.071	1.071	1.195	1.195	1.195	1.195	1.468
Height (mm)	mm	1.417	1.417	1.615	1.615	1.615	1.615	1.982
Net weight (kg)	Kg	438	471	886	926	1.063	1.190	1.900
Dimensions with packaging								
Width (mm)	mm	1.072	1.262	1.464	1.608	1.903	2.310	1.890
Depth (mm)	mm	1.102	1.102	1.300	1.300	1.300	1.300	1.540
Height (mm)	mm	1.530	1.530	1.742	1.742	1.742	1.742	2.150
Gross weight (kg)	Kg	459	494	906	946	1.085	1.220	1.958
Volume (m³)	m³	1,81	2,13	3,27	3,6	4,26	5,17	6,26

*Fagor reserves the right to modify the technical data without prior warning.



ONNERA GROUP

